

NOTES:

1. 6 1/4" Taper Top Form shown

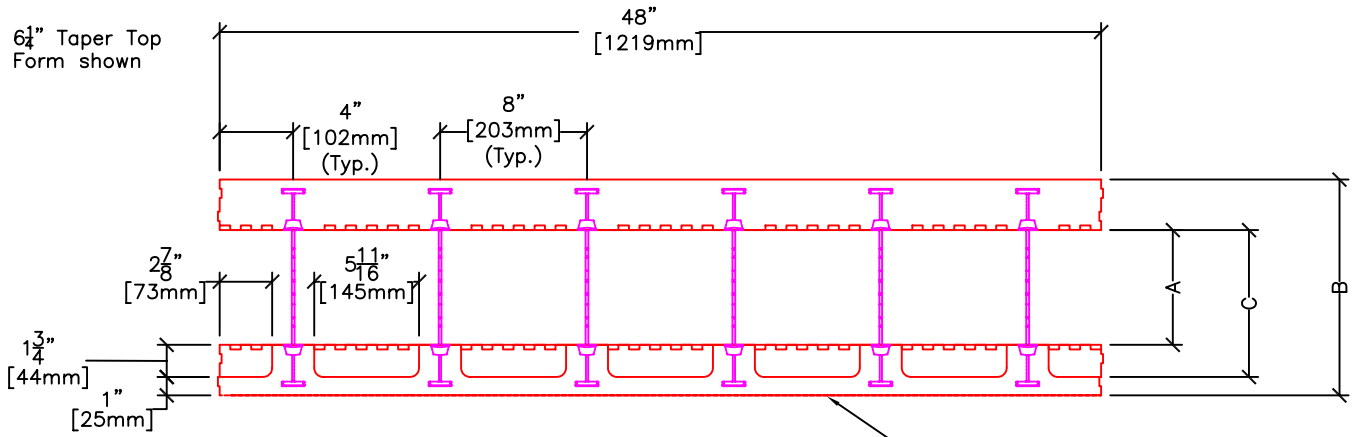

PLAN VIEW

2 3/4" (70mm) panels

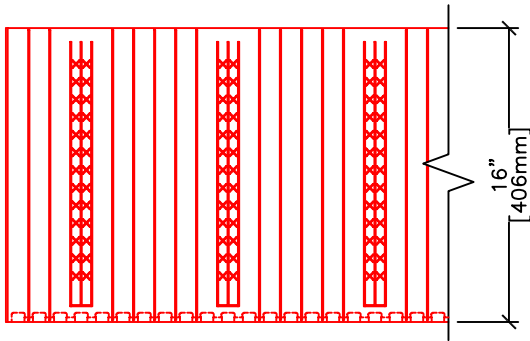

SIDE ELEVATION

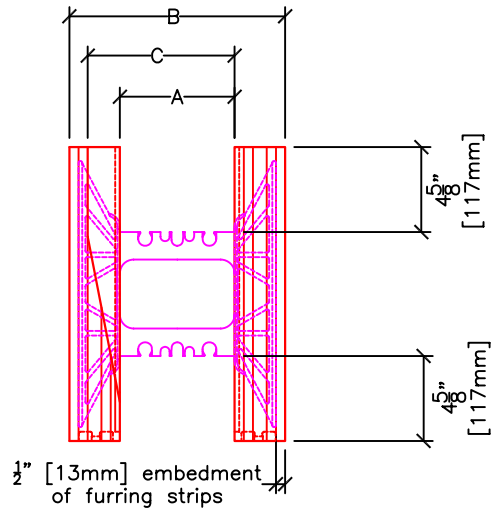

END VIEW

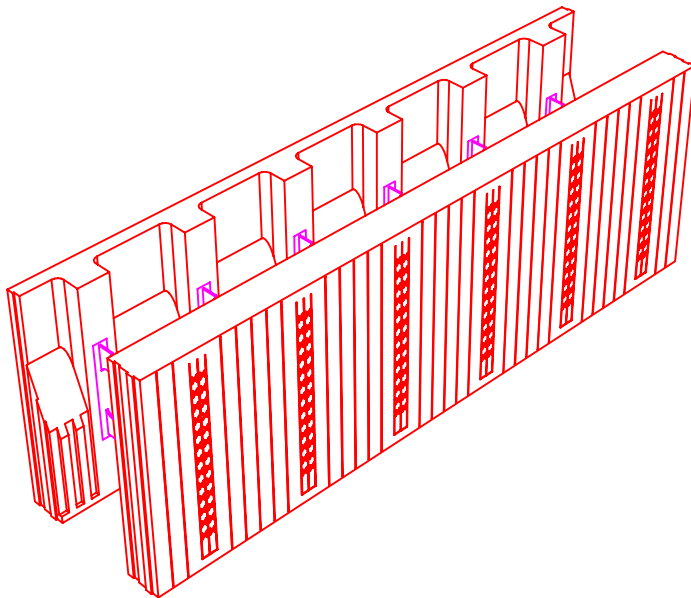

FORM SIZES				
	4" (102mm)	6.25" (159mm)	8" (203mm)	10" (254mm)
A	-	6.25" (159mm)	8" (203mm)	10" (254mm)
B	-	11.75" (298mm)	13.5" (343mm)	15.5" (394mm)
C	-	8" (203mm)	9.75" (248mm)	11.75" (298mm)